



2,433 SF & 3,808 SF BUILDINGS ON 1.1 ACRES

**RETAIL OPPORTUNITY**  
1145-65 ELMHURST RD, DES PLAINES, IL  
**FOR SALE OR LEASE**

**REDEVELOPMENT POSSIBILITY**

**CONTACT: STEVEN BAER** [sbaer@metrocre.com](mailto:sbaer@metrocre.com) 847.412.9898



## PROPERTY HIGHLIGHTS

- 21,704 SF (0.4982 AC) 3,808 SF Building
- 26,052 SF (0.5981 AC) 2,433 SF Building
- » Total SF/Ac = 47,756 Sf (1.0963)

## DEMOGRAPHICS

	1 MILE	3 MILES	5 MILES
TOTAL POPULATION	17,712	108,489	251,658
DAYTIME POPULATION	14,666	143,101	344,169
HOUSEHOLDS	7,225	44,031	101,513
AVG HH INCOME	\$69,022	\$94,590	\$104,697

## TRAFFIC COUNTS

ELMHURST RD	35,076 VPD
ALGONQUIN RD	15,410 VPD
DEMPSTER ST	8,899 VPD

## AREA TENANTS INCLUDE

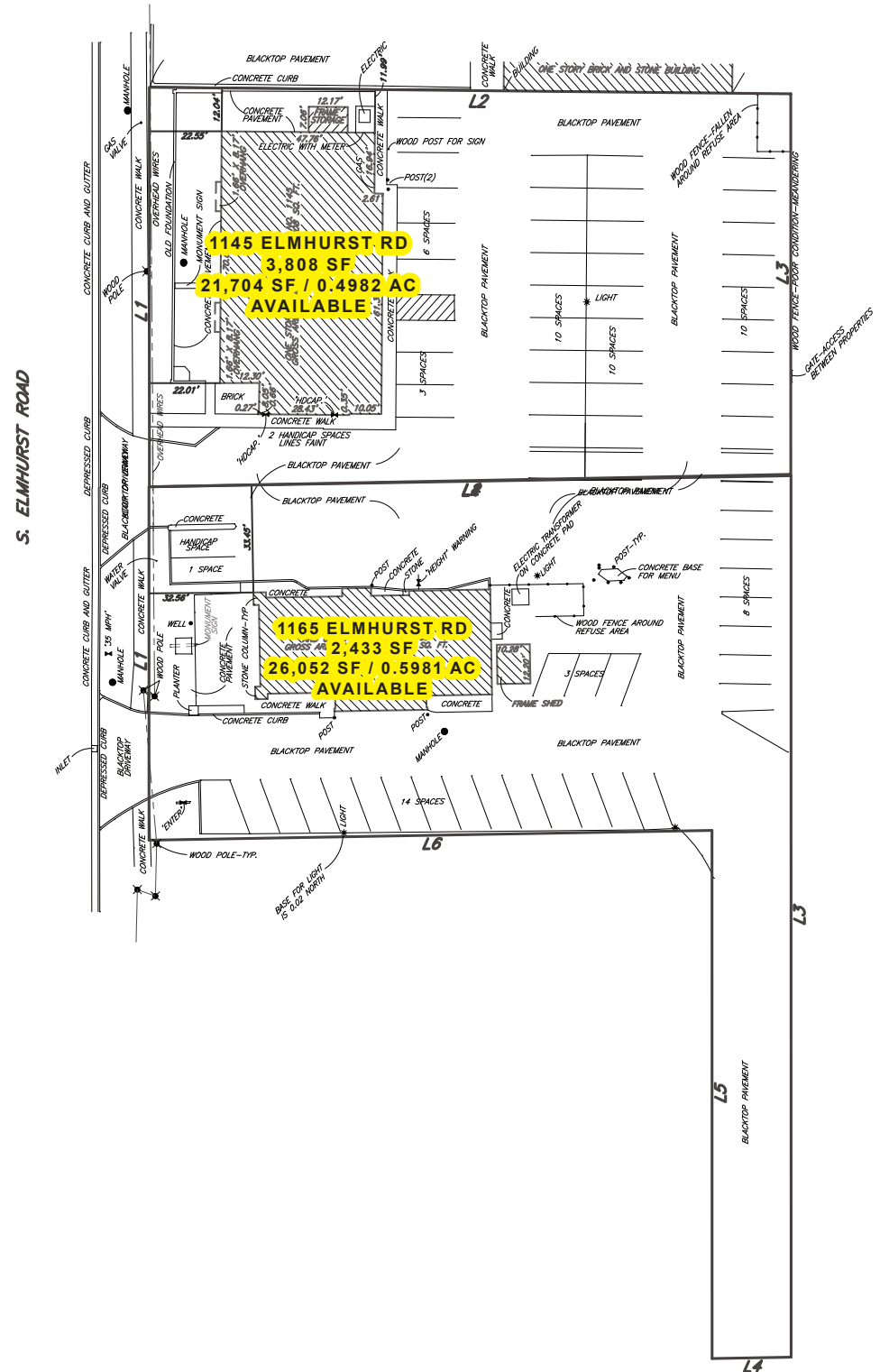

# RETAIL OPPORTUNITY

1145-65 ELMHURST RD, DES PLAINES, IL

FOR SALE OR LEASE



CONTACT INFORMATION:

**STEVEN BAER**  
sbaer@metrocre.com  
847.412.9898

56 Skokie Valley Road  
Highland Park, Illinois 60035  
www.MetroCRE.com



# RETAIL OPPORTUNITY

1145-65 ELMHURST RD, DES PLAINES, IL

FOR SALE OR LEASE

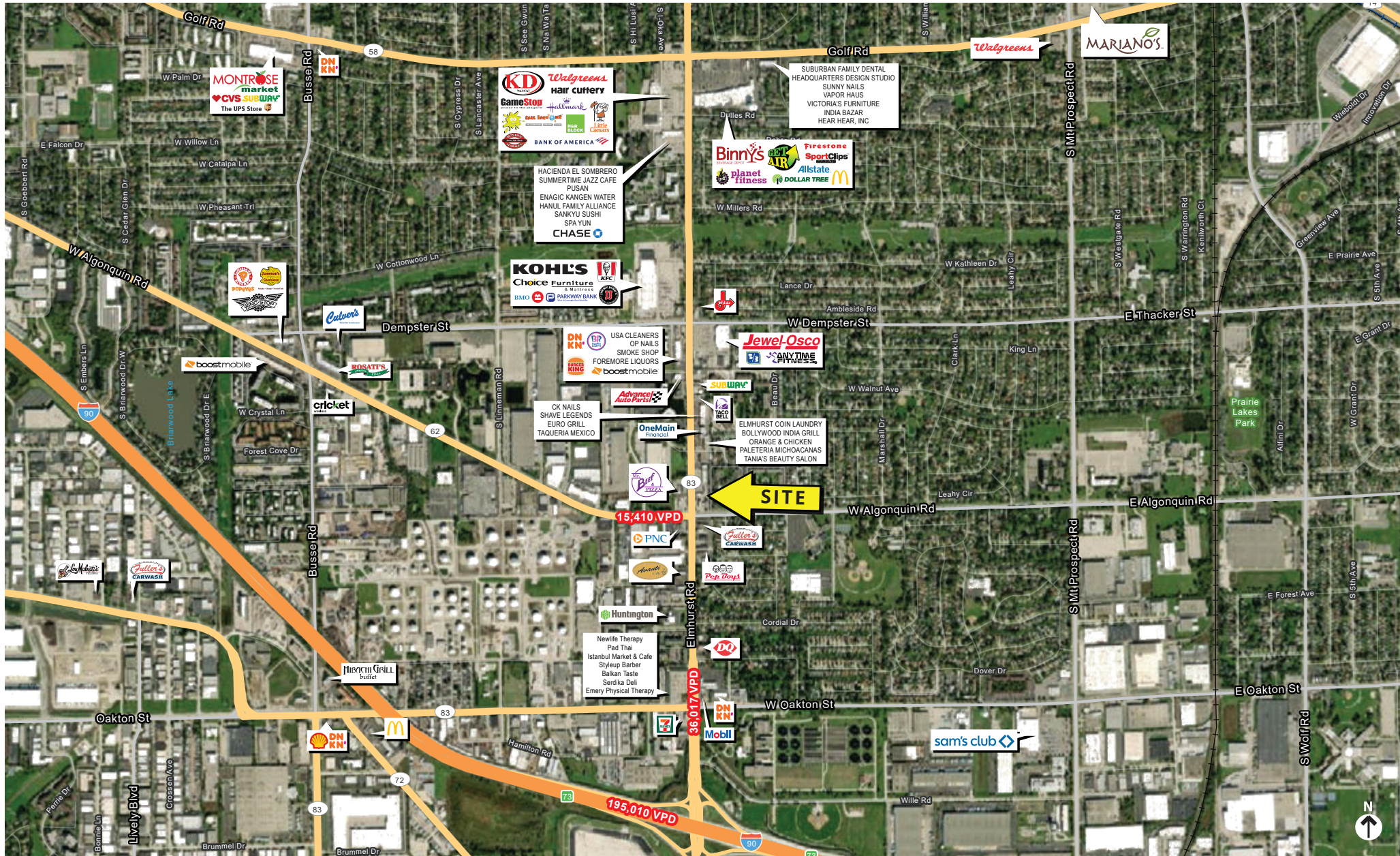

**CONTACT INFORMATION:**  
**STEVEN BAER**  
 sbaer@metrocre.com  
 847.412.9898

56 Skokie Valley Road  
 Highland Park, Illinois 60035  
[www.MetroCRE.com](http://www.MetroCRE.com)

**METRO**  
 COMMERCIAL REAL ESTATE