

# Flavor 20 Club

1114 - 1126 LAKE STREET, DOWNTOWN OAK PARK, IL.



**NOW LEASING! MOTIVATED LANDLORD**  
**UP TO 16,243 SQ FT OF RETAIL SPACE AVAILABLE**



CONTACT: SHARON BAR-SHALOM sbarshalom@metrocre.com 847.780.1299 // ROBERT MELSER rmelser@metrocre.com 847.412.9898



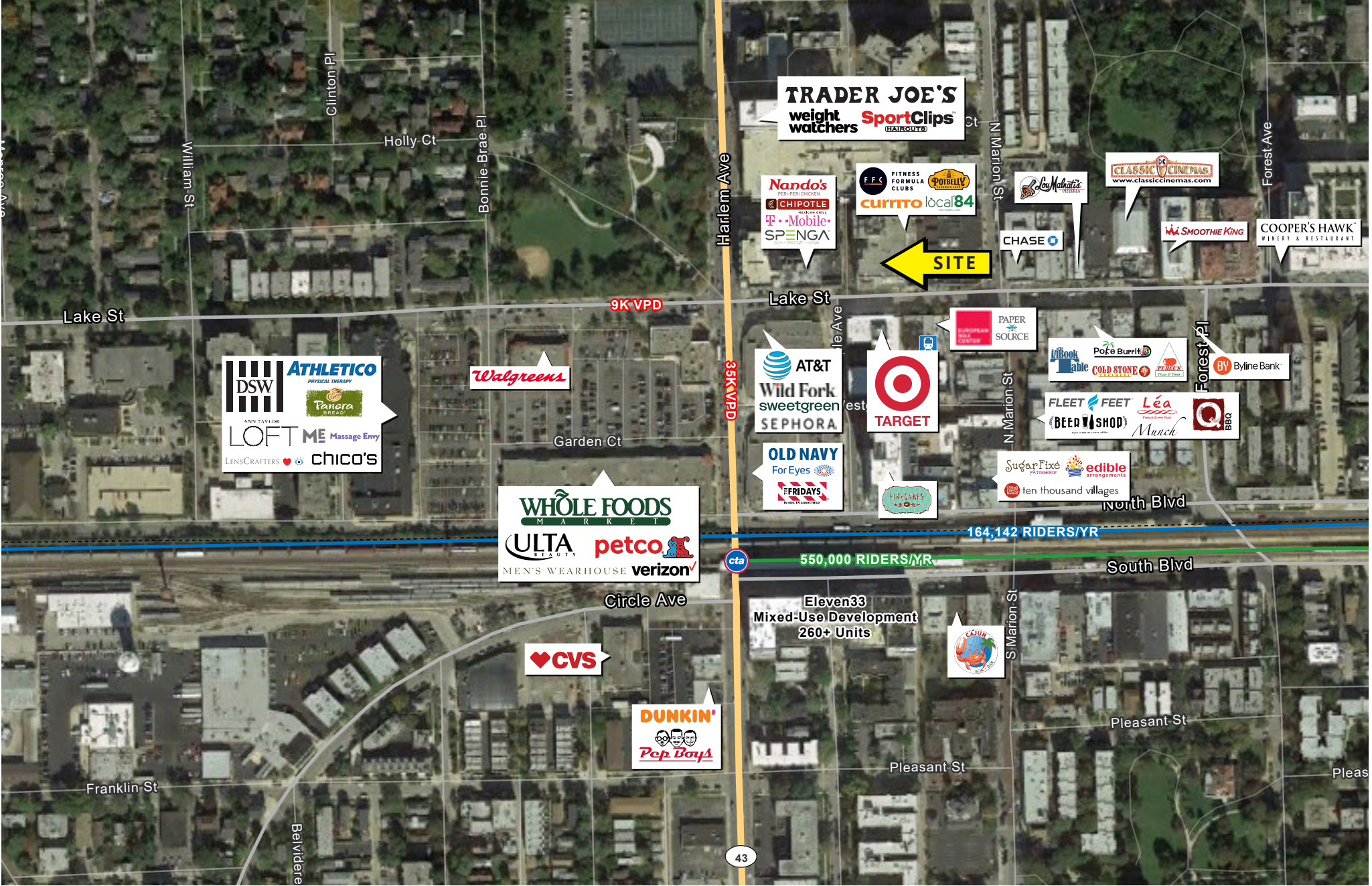



# Eleven 20 Club

## PROPERTY HIGHLIGHTS

- Up to 16,243 SF Located the Heart of Downtown Oak Park's Retail Corridor
  - » 1,289 SF / 1,720 SF / 5,020 SF Retail Units
  - » 2,227 Sq Ft Fully Fixtured Bakery
  - » 5,987 Sq Ft Endcap Restaurant w/ Black Iron
- One Block East of Harlem (35K VPD), Fronting Lake St (9K VPD)
- Free Parking up to 1 Hour at Public Garage w/ 1,213 Spots
- Top Performing Formula Fitness Club (FFC) Anchor
- Close Proximity to CTA & Metra Stations:
  - » CTA Green Line (550,000 average ridership per year)
  - » CTA Blue Line (164,142 average ridership per year)
  - » Oak Park Metra (350,000 average ridership per year)

## DEMOGRAPHICS

	½ MILE	1 MILE	2 MILES
TOTAL POPULATION	11,740	34,432	118,153
DAYTIME POPULATION	10,446	22,836	71,275
HOUSEHOLDS	6,678	17,318	50,183
AVG HH INCOME	\$130,781	\$154,501	\$142,224

## TRAFFIC COUNTS

**35k**  
N HARLEM AVE  
VEHICLES PER DAY

**9k**  
LAKE STREET  
VEHICLES PER DAY

## WALK SCORE

**98**  
WALK SCORE  
WALKER'S PARADISE  
Daily Errands Do Not Require a Car

**60**  
TRANSIT SCORE  
GOOD TRANSIT  
Many Nearby Public Transportation Options



# Eleven 20 Club

1114 - 1126 LAKE STREET, DOWNTOWN OAK PARK, IL.

HOLLEY COURT PUBLIC PARKING GARAGE  
1,213 PUBLIC SPACES

SUITE	SQ FT
1116	1,289
1118	2,227
1120	5,020
1122	5,987
1128	1,720

UP TO 16,243 SF (COMBINED)

MAPLE AVENUE

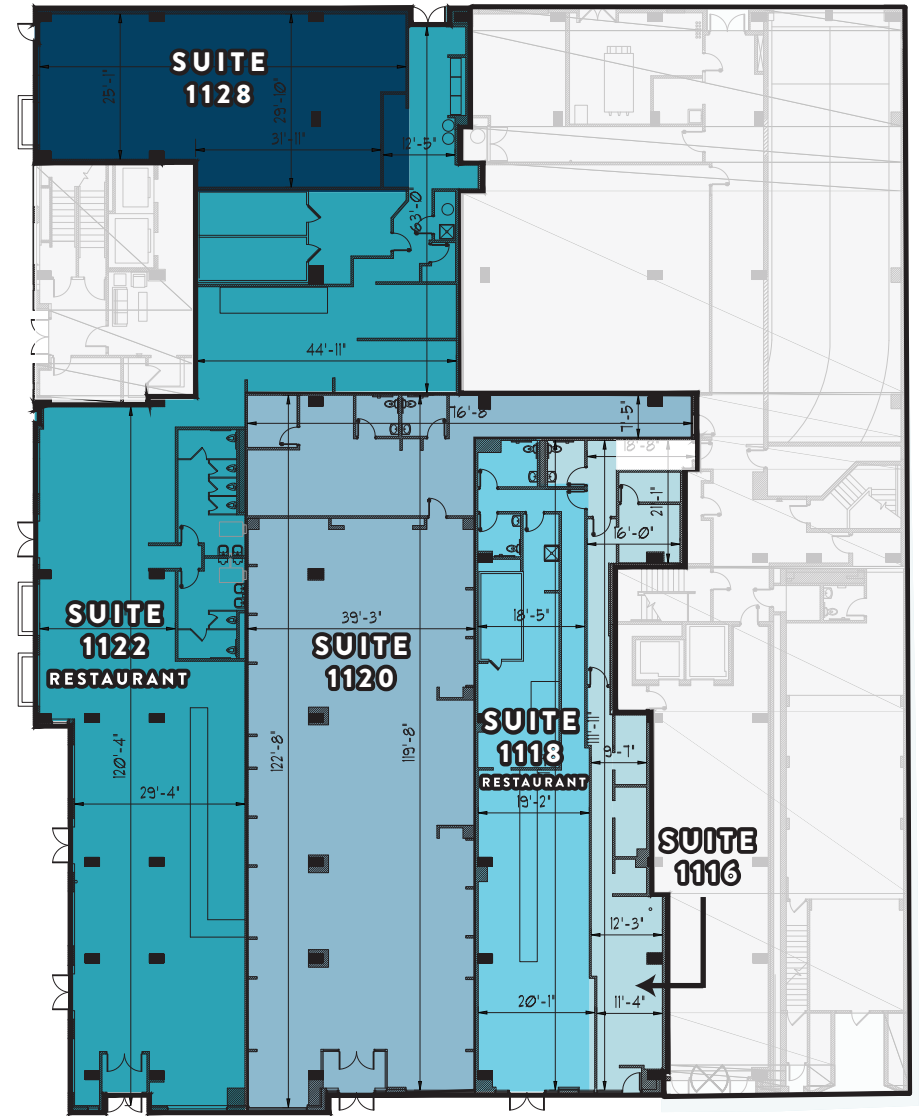

LAKE STREET

# LEASING CONTACTS

---

## SHARON BAR-SHALOM

SBARSHALOM@METROCRE.COM

847.780.1299

## ROBERT MELSHER

RMELSHER@METROCRE.COM

847.412.9898



[WWW.METROCRE.COM](http://WWW.METROCRE.COM)

© 2021 METRO COMMERCIAL REAL ESTATE. ALL RIGHTS RESERVED. ALL INFORMATION CONTAINED HEREIN IS FROM SOURCES DEEMED RELIABLE; HOWEVER, NO REPRESENTATION OR WARRANTY IS MADE TO THE ACCURACY THEREOF.